

Pocket Speakerphone Hub AS315

User Guide

Table of Contents

Introduction.....	2
Pocket Speakerphone Hub AS315.....	3
Key Features.....	3
System Requirements	4
Technical Specifications	4
Product Overview.....	5
Installation.....	6
LED Indicators	7
Contact Us.....	7
About AVerMedia	7
Appendix – F.A.Q.	8

Introduction

This document is your User Guide for the Pocket Speakerphone Hub AS315. We have written this guide to provide you with the information you need to quickly and smoothly use the speakerphone.

After a quick introduction of the speakerphone and who this product is intended for, we will dive into its key features, system requirements, and technical specs and show you how to set up and install the device. Lastly, this guide will finish with a link to our technical support team and with some brief information on AVerMedia's background.

Thank you for taking the time to use and try out our latest speakerphone, we hope you enjoy using it as much as we enjoyed making it. If you have any questions or suggestions on our products or need any further editorial assistance, please don't hesitate to contact us.

Pocket Speakerphone Hub AS315

The Pocket Speakerphone Hub AS315 can be used as a multi-port hub and a speakerphone. The compact design takes up tiny space from a home office to a small huddle room. It is ultra portable for business trips that users can easily put the speakerphone hub into a bag and takes it to travel anywhere, empowering the anyplace workspace.

With an efficient cable management feature, the compact and lightweight design of the Pocket Speakerphone Hub AS315 features a collection of ports to plug in devices that will help empower the anyplace workspace and make it look organized.

It uses artificial intelligence to accurately identify and reduce common background noises in offices, such as keyboard typing sounds, coffee machine sounds, fan noise, and so on, allowing important conversations, presentations, and training lessons to proceed without interruption.

Key Features

- One cable connects the essentials you need to join a meeting and start working.
Ports:
 - HDMI 1.4 port (4K@30 Hz)
 - USB 3.2 Gen 2 Type-A port (Super Speed 10 Gbps)
 - USB 3.2 Gen 2 Type-C port (Power Delivery up to 100 W)
- One click to activate AI noise reduction. With AI-powered technology, the AS315 suppresses distracting background noises.
- Keeping a clean and tidy workspace that aligns your workspace with workflow and significantly improves efficiency.
- Portable design for personal use at home, work, and on the go.
- Push to talk/mute at once. Easily mute/unmute your audio with a touch of a button.
- Avoid ear pain or hearing damage from prolonged use of headphones or earbuds.
- You can be sitting down or walking around your workspace while having a group call.
- Compatible with your favorite conferencing software.

System Requirements

Speakerphone

- Windows (include surface), macOS (MacBook and iMac), Chromebook
- Available USB Type-C port (*with DP Alt mode for HDMI output)

Compatible with 3rd Party Software

- Teams, Zoom, Google Meet, Cisco Webex, Skype, GotoWebinar, Wechat, Messenger, YouTube, Line, FaceTime

Technical Specifications

Connection	Plug and Play (no driver needed) USB Type-C, Manageable Pigtail Cable 43 cm / 17.05 in
I/O Ports	1 x HDMI 1.4 port (4K @ 30Hz) 1 x USB 3.2 Gen 2 Type-A port (10 Gbps) 1 x USB 3.2 Gen 2 Type-C port (10 Gbps; Power Delivery up to 100 W)
Speaker	3 W Frequency Response: 150 Hz – 14 kHz
Microphone	360°; Omnidirectional Frequency Response: 100 Hz – 7 kHz Pickup Range: 3 m / 9.8 ft
Interface	AI Noise Reduction, Microphone Mute, Volume Up, Volume Down with LED Indicators
Dimensions (D x H)	96 x 29.5 mm (3.8 x 1.2 in)
Weight	145.4 g (5.1 oz)
What's in the Box	AS315 Speakerphone Hub Carrying Bag Quick Guide

*All specifications are subject to change without prior notice.

*Visit AVerMedia official website at www.avermedia.com for the latest information.

Product Overview

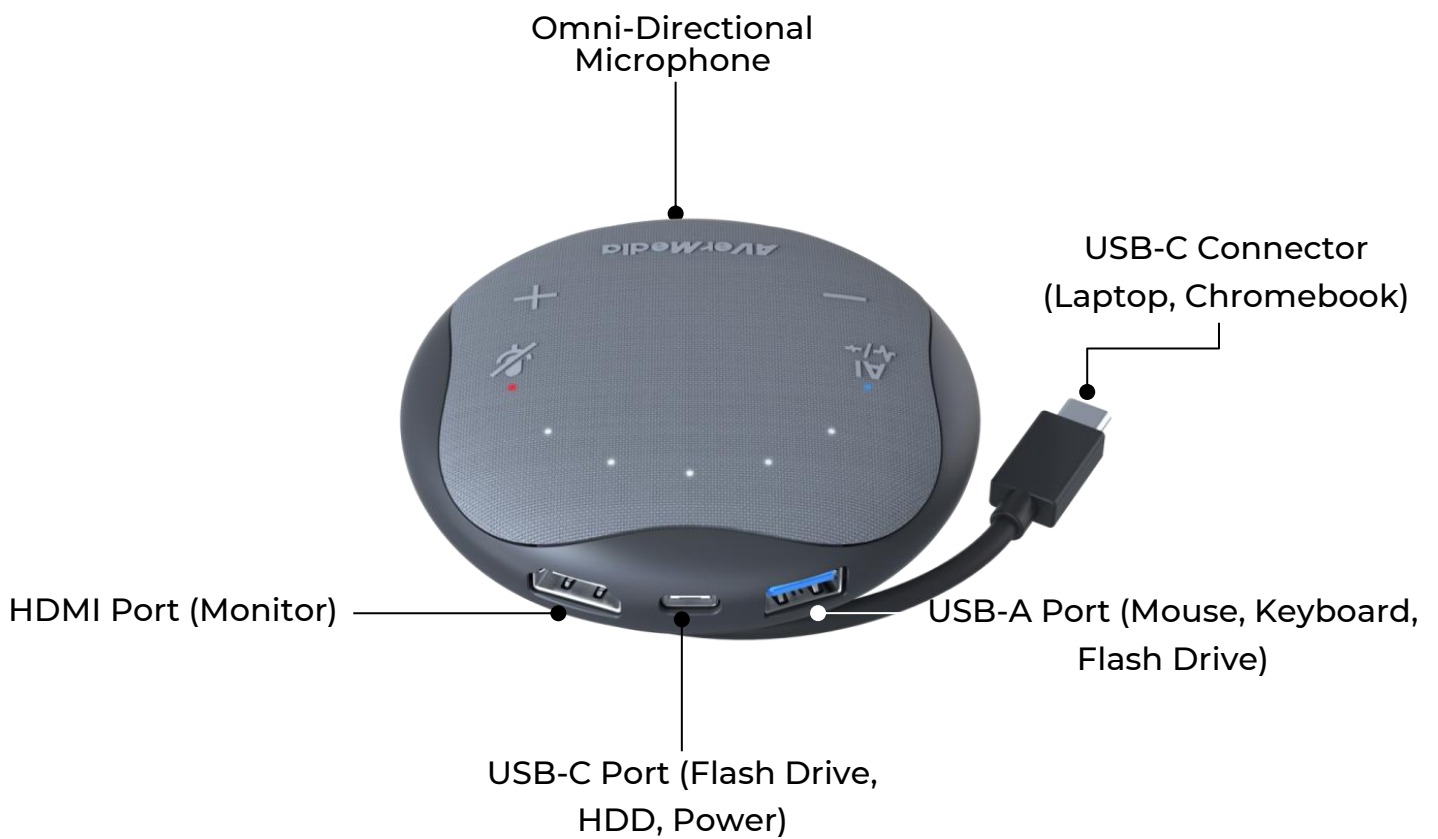

Installation

Connect AS315 to your computer via the built-in USB Type-C cable.

Once connected, the speakerphone will automatically function as your computer's default speaker and microphone device, namely AVerMedia Speakerphone AS315.

You can also connect a monitor, keyboard, webcam, etc. to it as a docking station.

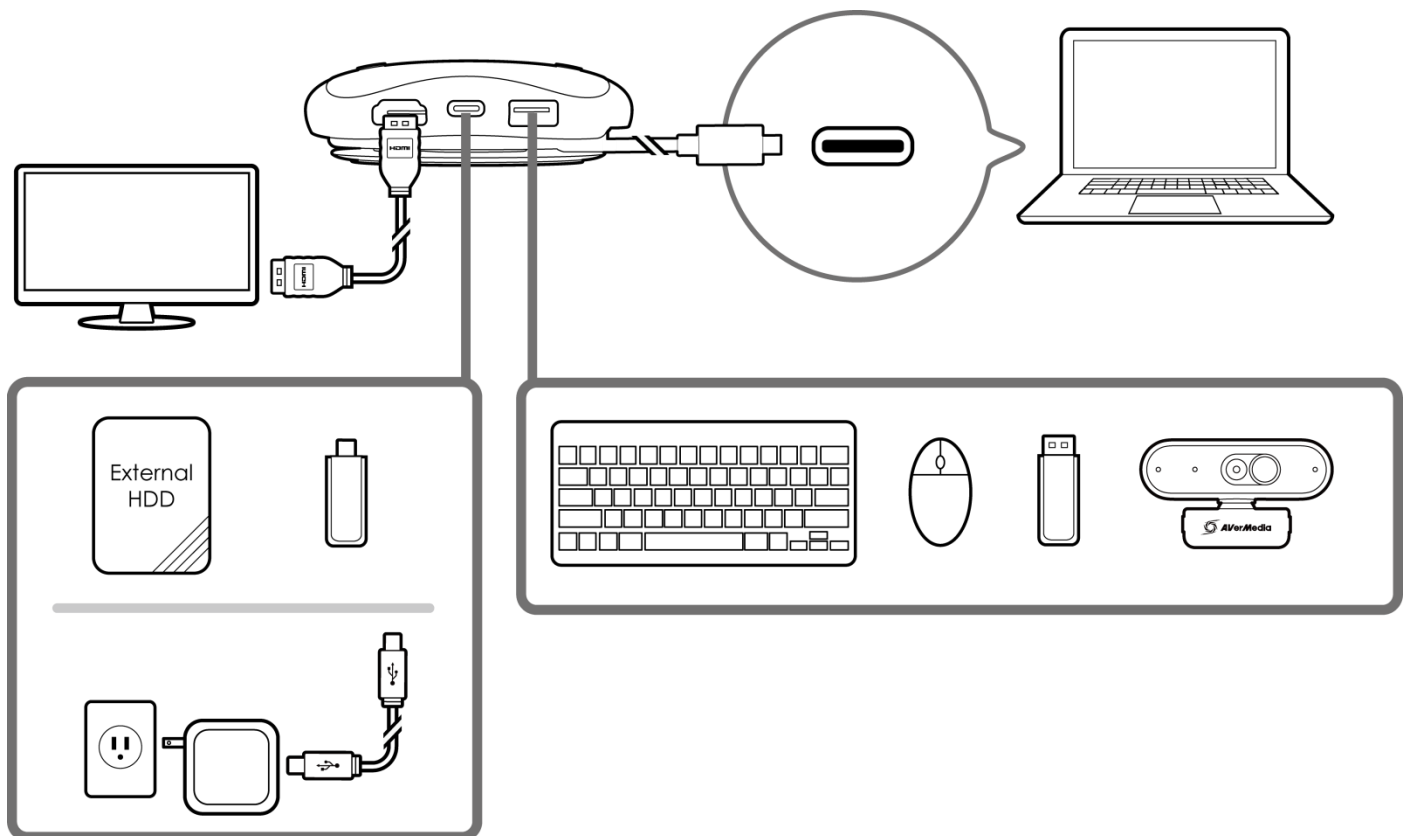

Note: Make sure your USB Type-C port supports **DisplayPort Alt Mode** for videos to work on AS315's HDMI port.

LED Indicators

Volume Indicator(s)	Status
Flashing white	Starting up/processing
Solid white (at volume level)	Ready
AI Indicator	Status
Solid blue	AI noise reduction enable
Mlc. Mute Indicator	Status
Solid red	Microphone muted

Contact Us

Please contact us [here](#) should you have any questions or suggestions.

About AVerMedia

AVerMedia empowers people to easily connect and boldly create through innovative audiovisual technology. Our solutions help people work productively, build new relationships, and expand their horizons in ways that weren't possible before. Our products include a wide range of powerful yet easy-to-use devices such as speakerphones, video capture cards, and microphones for content creators, schools, and businesses. We also provide hardware design services for a range of AI and IoT applications, from smart retail to smart cities.

AVerMedia is guided by a philosophy of contributing to society- whether through products that change customers' lives for the better or by ensuring our operations are socially responsible.

Connect with AVerMedia:

Website: <https://www.avermedia.com/>

LinkedIn: <https://www.linkedin.com/company/avermedia-technologies>

Appendix – F.A.Q.

1. Is my computer's USB Type-C port able to output videos to AS315?

Make sure the USB Type-C port in use supports DisplayPort Alt Mode, Thunderbolt 3, or 4 projection for videos to be exported through AS315 and to display on a monitor or TV.

How to identify if a USB Type-C port supports DisplayPort Alt Mode or Thunderbolt 3 / 4 projection?

Check if there is one of the following symbols next to the USB Type-C port:

- A lightning bolt symbol indicating Thunderbolt 3 or 4



- A D-shaped icon indicating DP Alt Mode



2. When using a non-Apple power adapter to power an iPad plugged into AS315, the connection between the iPad and AS315 sometimes got disconnected. How to fix it?

Please use genuine Apple USB power adapters to ensure stable connection and to avoid possible incompatibility with non-Apple power adapters.

3. There is no mute button for AS315's speaker. How to mute the speaker directly?

Keep pressing on the volume “–” button until all the volume indicators go off. Another way is to mute the volume from the computer's keyboard shortcut or system audio settings.



4. There is no audio device selection on the iPad, and both my monitor and AS315 have speakers, how to output sound from the AS315 instead of my monitor?

iPad's design is to output sound to the audio device which gets connected at last. Refer to the following connection sequence, to get audio output from AS315.

- I. Connect the monitor to AS315's HDMI port.
- II. Connect AS315's built-in USB Type-C cable to the iPad.
- III. If a power supply is needed, plug it into AS315 at the last step.

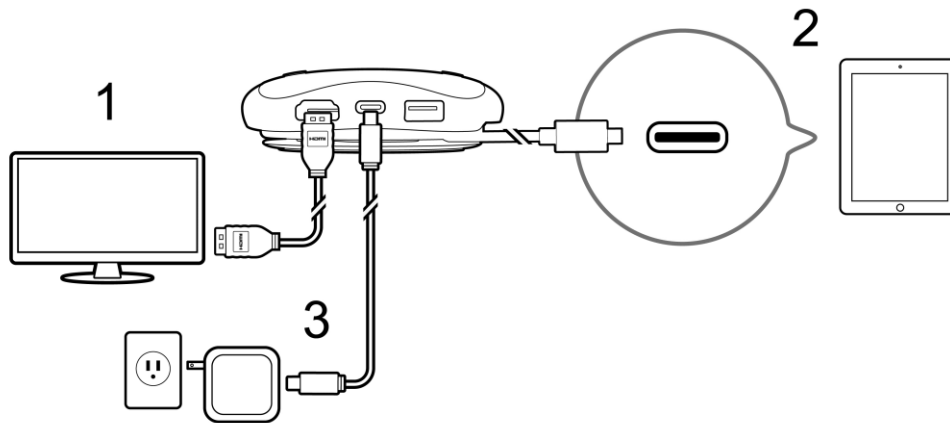

Speakerphone support page:

<https://www.avermedia.com/Speakerphone-Support>